

TRUCK OK  
NOT STAKED

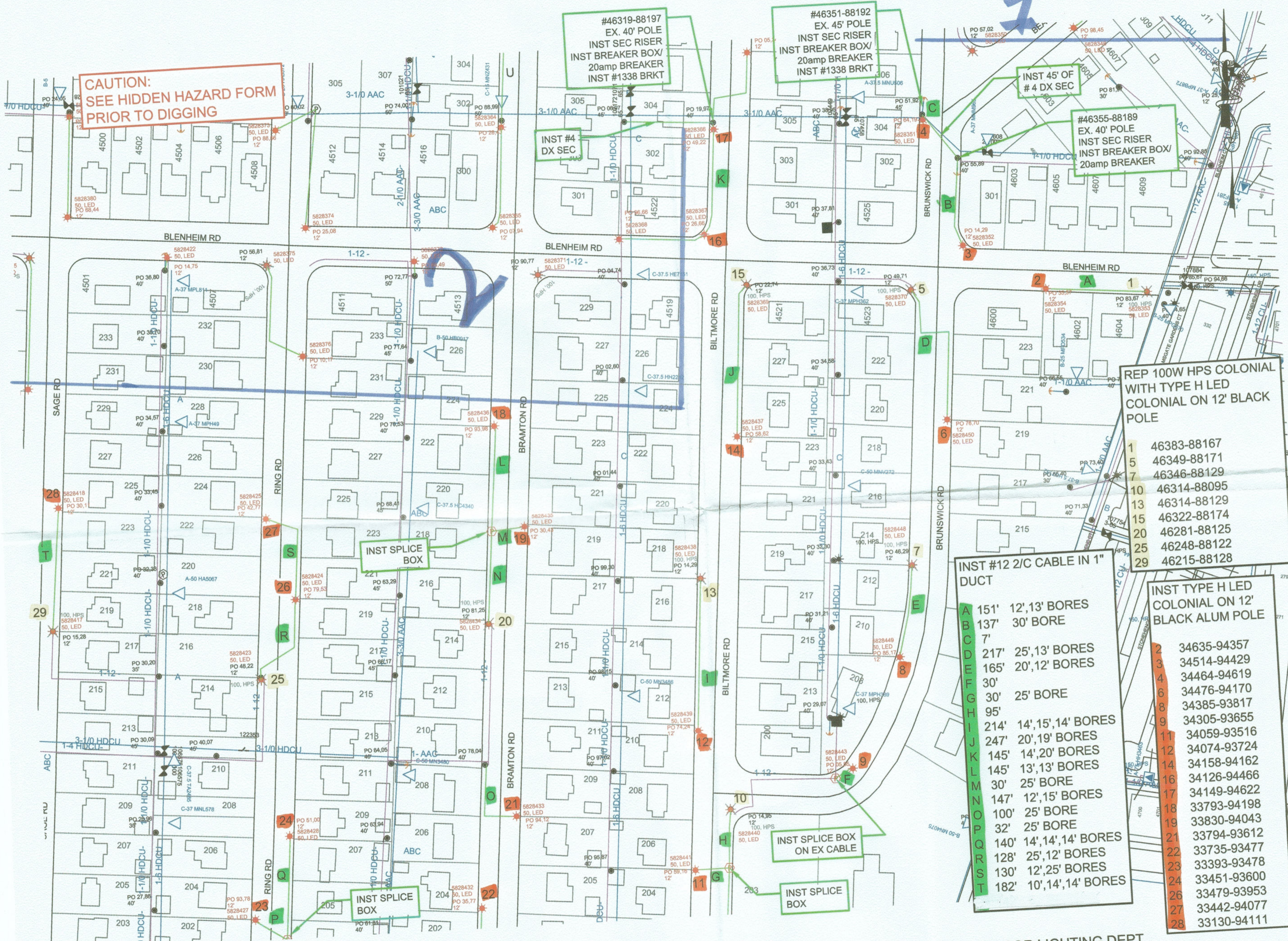

**CAUTION:**  
SEE HIDDEN HAZARD FORM  
PRIOR TO DIGGING

INST 45' OF  
# 4 DX SEC

INST SPlice BOX

INST #12 2/C CABLE IN 1" DUCT

|   |      |                   |
|---|------|-------------------|
| A | 15'  | 12',13' BORES     |
| B | 137' | 30' BORE          |
| C | 7'   |                   |
| D | 217' | 25',13' BORES     |
| E | 165' | 20',12' BORES     |
| F | 30'  | 25' BORE          |
| G | 30'  | 25' BORE          |
| H | 95'  |                   |
| I | 214' | 14',15',14' BORES |
| J | 247' | 20',19' BORES     |
| K | 145' | 14',20' BORES     |
| L | 145' | 13',13' BORES     |
| M | 30'  | 25' BORE          |
| N | 147' | 12',15' BORES     |
| O | 100' | 25' BORE          |
| P | 32'  | 25' BORE          |
| Q | 140' | 14',14',14' BORES |
| R | 128' | 25',12' BORES     |
| S | 130' | 12',25' BORES     |
| T | 182' | 10',14',14' BORES |

REP 100W HPS COLONIAL WITH TYPE H LED COLONIAL ON 12' BLACK POLE

|    |             |
|----|-------------|
| 1  | 46383-88167 |
| 5  | 46349-88171 |
| 7  | 46346-88129 |
| 10 | 46314-88095 |
| 13 | 46314-88129 |
| 15 | 46322-88174 |
| 20 | 46281-88125 |
| 25 | 46248-88122 |
| 29 | 46215-88128 |

INST TYPE H LED COLONIAL ON 12' BLACK ALUM POLE

|    |             |
|----|-------------|
| 2  | 34635-94357 |
| 3  | 34514-94429 |
| 4  | 34464-94619 |
| 6  | 34476-94170 |
| 8  | 34385-93817 |
| 9  | 34305-93655 |
| 11 | 34059-93516 |
| 12 | 34074-93724 |
| 14 | 34158-94162 |
| 16 | 34126-94466 |
| 17 | 34149-94622 |
| 18 | 33793-94198 |
| 19 | 33830-94043 |
| 21 | 33794-93612 |
| 22 | 33735-93477 |
| 23 | 33393-93478 |
| 24 | 33451-93600 |
| 26 | 33479-93953 |
| 27 | 33442-94077 |
| 28 | 33130-94111 |

**JOB BRIEFING**

- HAZARDS ASSOCIATED—WITH THE JOB
- WORK PROCEDURES INVOLVED
- SPECIAL PRECAUTIONS
- ENERGY SOURCE CONTROLS
- PERSONAL PROTECTIVE EQUIPMENT REQUIRED

SIGNATURE \_\_\_\_\_  
ATTENDEES \_\_\_\_\_

RETURN TO OUTDOOR LIGHTING DEPT  
WORKMAN

DATE WORK COMPLETED \_\_\_\_\_

